

**Bidet mixer**

**bathco**

info@bathcogroup.com

**Tasos**  
**Ref. 18098**

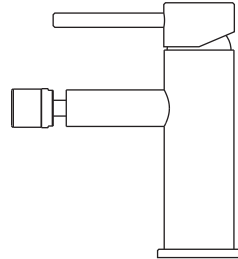

## INSTALLATION INSTRUCTIONS

---

Before proceeding with installation, please read these instructions carefully to familiarise yourself with the required tools, materials and installation steps. Please leave these instructions for the consumer after installation.

Prior to installation, inspect the bidet mixer to ensure that no damage has occurred in transit. If damage has occurred, or a visible defect exists, do not proceed with installation, and advise your supplier immediately.

### Tools and material required

---



Allen key



Screwdriver  
(not included)



Spanner  
(not included)



Inlet hoses



Mixer



Fixing kit

## Installation

- 1** This basin mixer is designed to be installed in a 32-38mm hole in diameter and at a minimum distance from the wall of 100 mm.

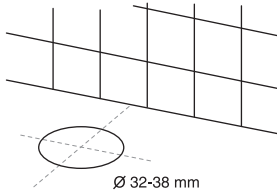

- 2** Flush any contaminants that may have been left in the supply lines for 30-60 seconds until the water runs clear.

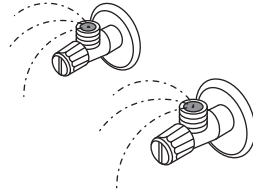

- 3** Fit the fixing kit from the bottom and insert the hot and cold water hoses from the bottom up.

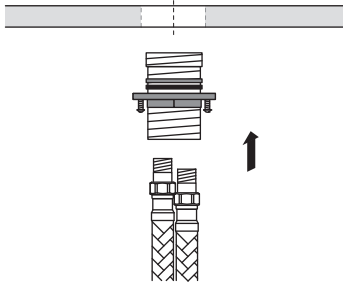

- 4** Fix the inlet hoses to the mixer body.

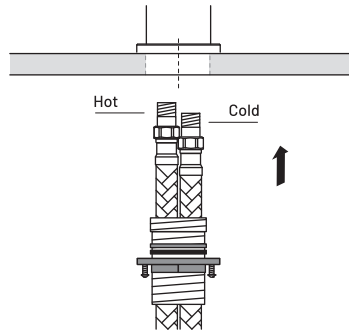

- 5** Screw off the washers from the fixing kit and screw the extension into the mixer body.

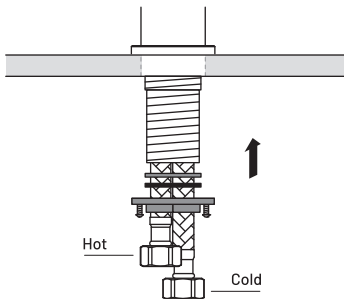

- 6** Fit the body of the mixer and tighten the fixing kit. Attach the end of the hoses to the angle valves.

